

Tsuga Top

with Steve Parvot
Emma _____ to
look at Botzols.

8/7/14

166-31

$R=0.833$

Site	p	Δp	Δe	e calc	e map	time	R
(A) Trail head	29.32	0.00	—	—	2190'	9:30	$\frac{3040' - 2190'}{29.32'' - 21.30''} = \frac{850'}{8.02''} = 1.02''$ $= \frac{850'}{1.02''} = 0.833$
(B) enter 1 ^o , e-p#	— not measured on ascent —						
(C) trail junction	28.66	0.66	550	2740	2740'	10:05	
(D) SCAMPFL	28.55	0.77	641	2831			
(E) top of high ledge	28.35	0.97	808	2998		11:00	
(F) Summit Tsuga Top	28.30	1.02	850	3040✓	>3040'	11:15 to 11:20	
(G) Steve's soil pit	28.36	0.96	800	2990		11:25 ↓ 11:05	
(H) base NEM grove; 341 dbh	28.44	0.88	733	2923			
(I) Stumps, enter 2 ^o (e.p.)	28.52	0.80	666	2856	(e.p. #671)	11:40	
(J) on log road	28.56	0.76	633	2823		11:45	
(K) on old tumpke	28.74	0.58	483	2673		11:58	
(L) jc. log road & tpk.e.	28.70	0.62	516	2706		12:05	
(E) trail junction	28.65	0.67	588	2748	2740'	12:10	
(B) enter 2 ^o , e-p# 4 highest stumps	28.84	0.48	400	(2590)	(e.p. #4)		
(A) Trail head, Rate (47) hairpin turn	29.30	0.02 → 0.00	17	2206	2190'	12:53	

Note about air pressure (C) (A) nearly the same both on ascent & descent. Pressure was increasing when Canadian air mass moved in, but pressure was falling because of solar afternoon heating. ∴ Nil net change in pressure over a period of over 5 hours.

- (B) (e.p. #4) Previous elev. calcs along new 1980 trail. This calc. is at 2590'.
 p 166-3 6/10/85 betw. (A) & (B) (2539') Shows deck & branch log roads
 p 166-29 11/13/10 (L) road ends 2366' (blaze at 2609') still visible on trail
 p 174-20, 215/23/98 (C) log deck? 2387' [e.p. still on crest of ridge]
 p 170-34 9/18/10 (2560') at Lotline. 2700' along Denning Tpk.e.

(D) 2831' \$CAMOYL appears, beginning to turn purple and much larger than \$INT which persists in the shade. Canopy beginning to open up here with PCILI and RS. BC dom. See (F).

(DD) Steve's elev. is 2975. A single PB. PIN, CB, Streptopus.

There are 2 or 3 steep pitches and low ledges beneath the high ledge at (F). Between one pair of the low ledges, on a gently-sloping terrace, is an isolated SUB grave.

(E) 2998' Top of high ledge. Ramp near W end allows an easy ascent. Enter NEM grove, especially on W shoulder of crest. Mor humus. Scatt. SORB seedlings

(F) 3040' Summit. \$INT only in hemlock shade. 12" to 18" to 24" tall only. No \$CAMOYL because of absence of canopy gaps.

(G) 2900' Steve's soil pit on SW shoulder, just above the high ledge on the south. Below ledge to SE is hard-wood forest

Soil profile { 0" to 6" Humus, O horizon
6" to 12" E horizon
Podzol { 12" to 18" B horizon
Very stony, maybe 70% by volume.

Steve says hemlock creates the most acidity to facilitate podzol leaching, even more than spruce & fir. Tannins abundance may be responsible in part.

MK noted what looked like 2 dead small firs standing, ca. 6" dbh, with wood sampled from one of them. Branch stubs in pseudowhoals, unlike hemlock & wood very soft & papery.

(H) 2923' Descending steeply the W shoulder. Low ledge & boulders. 34" dbh NEM measured at base of NEM grove. Abun. SORB seedlings and mature SORB atop ledge above.

(I) 2856' Base of steep W slope. Stumps begin from 1970s Winnisnook logging. New e-p # 671. More SUB-B below

(J) 2823' Follow log road down a short distance. Overgrown with beech sprouts and several dunned dead PINS across it. Turn W & descend directly to old tumpike.

(K) 2873' On old tumpike. Pass lat seep & 2 possible log decks free of old trees and heavy with DP. Then at (K), join log road (J)

(B) 2590' There is a problem with e-p # 4. It was originally located at the Giant ledge lean-to site, but must be moved in the FIRST GROWTH files, to this point (B) along the new 1980 trail. Stumps end here. See additional field notes pp for elev. Cales. on bottom of page 166-31. Winnisnook Club reached the SW line here in 1970s and stopped logging.

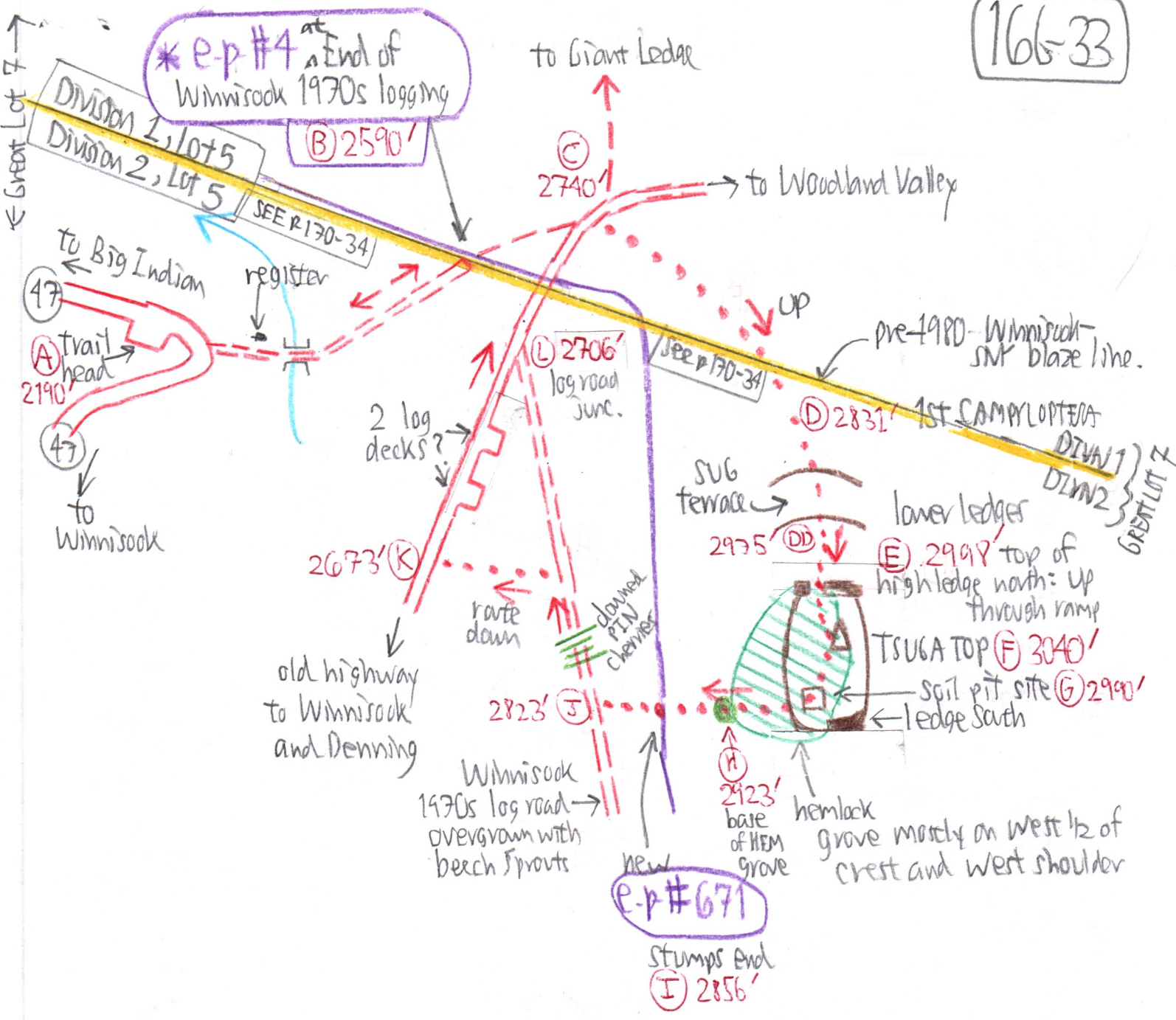

* See other estimates of elev. of (e.p.#4) at bottom of page 166-31
 (e.p.#4) had initially been placed on the Grant ledge lean to site, but has since been moved down here to (B).